

GS-8601HV

Digital Brushless Servo

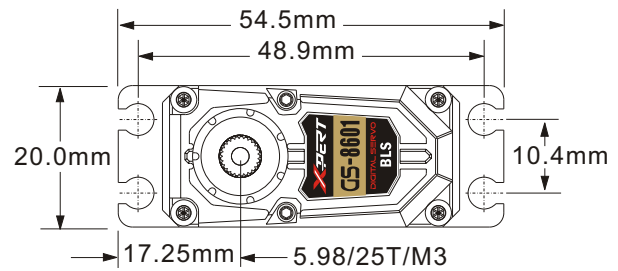
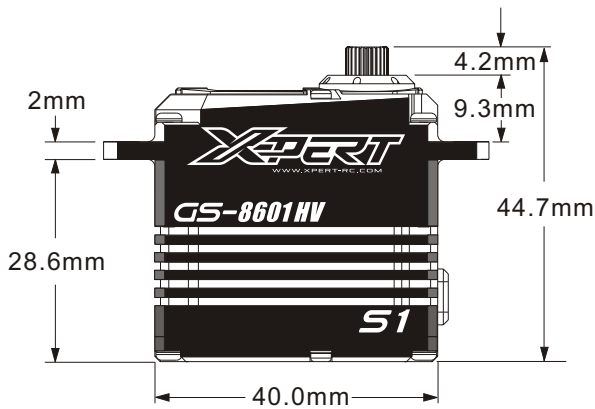

Input voltage : 5V~8.4V DC
Maximum current : 6.5~7A
Frequency Range: 50~1000HZ (auto adaptive)
PPM Range : 250us-500us, 500us-1000us, 1000u-2000us(auto adaptive)
Dimensions : 40.0mm*20.0mm*44.3mm
Weight: 71/g (without wires)

S1 Speed : 45°/60°

6.0V: 0.116/0.153 sec
7.4V: 0.098/0.131 sec
8.4V: 0.093/0.124 sec

S1 Torque

6.0V: 25.9kg/cm/360 oz-in.
7.4V: 33.1kg/cm/460 oz-in.
8.4V: 40.0kg/cm/555 oz-in.

Available cables:

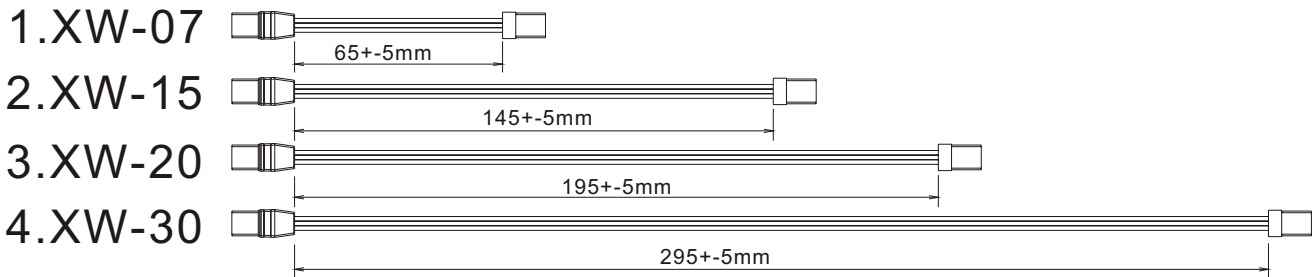

#1/2/3 are included with the servo, #4 is an optional.

Gear set: XGS-S291

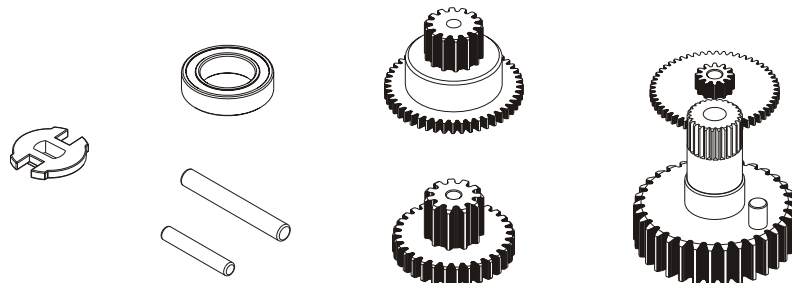

Note:

1. This servo does not support alkaline or dry cell type battery.
2. This servo must be installed with the included rubber grommets to absorb the vibrations and to increase the lifespan of the product.
3. This servo has a water resistance structure. However, it is not waterproof. It can damage the servo if it is submerged in water.
4. This servo has over temperature and over current protection. The operating temperature can go as high as 70°C/158°F under loading.
5. It can cause permanent damage by reverse polarity power. It is not covered by the limited factory warranty.
6. This servo supports most high-speed protocols on the market. The transmitter must have all channels at its neutral position when the servo is power on. Otherwise, the servo can have incorrect initialization and malfunction.